

Cassetted Roller Blind | Recess Installation

Fitting, operation and maintenance instructions

Warning! The operating instructions must be read before operating the blind.

Fitting Instructions for Cassetted Roller Blinds with side channels

This blind should be installed by a person competent in DIY. If in doubt please consult a professional.

Step 1 - Prepare the cassette

Your blind is supplied in separate parts: cassette, roller blind, and side channels. Remove the cassette cover by taking out the two safety screws located on the underside of the cassette. This allows the cover to open and the cassette to be prepared for fitting.

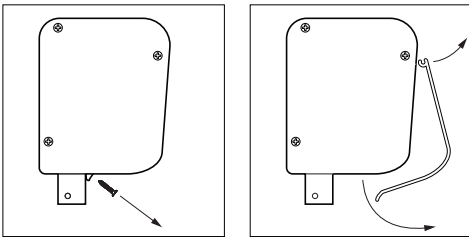

Step 2 - Drill cassette fixing holes

Using the indents inside the cassette as a guide, drill 3.8 mm fixing holes in the top of the cassette. Space the holes evenly, ensuring none are more than 1 m apart, to keep the cassette securely fixed and completely level.

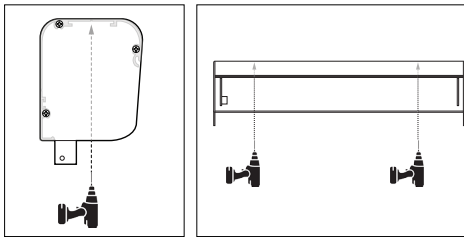

Step 3 - Drill side channel fixing holes

If the side channels are not pre-drilled, drill 5 mm fixing holes spaced no more than 1000 mm apart along their length. Next, drill 2 mm holes at the top of each side channel to allow for attachment to the cassette.

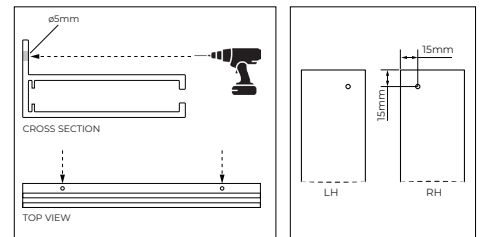

Step 4 - Attach side channels

Slot the side channels into the end plate lugs, then use the supplied screws to secure the cassette to the side channels through the lugs.

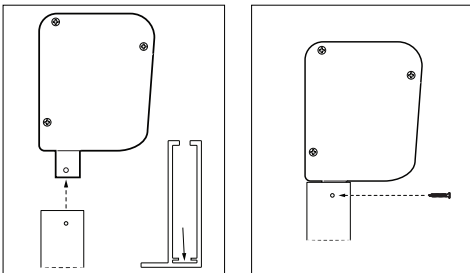

Step 5 - Fix the cassette

Using the previously drilled fixing holes, mark the screw positions with a pencil through the holes in the cassette. Drill and plug the wall as required, then securely fix the cassette using appropriate fittings (screws and fixings not supplied).

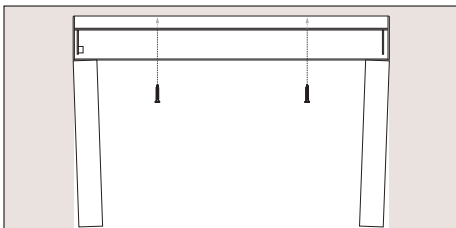

Step 6 - Install the roller blind

Remove the blind from its packaging. For chain-controlled blinds, thread the chain through the chain guide. Insert the idle end of the roller into its bracket, then clip the control end securely into the opposite bracket.

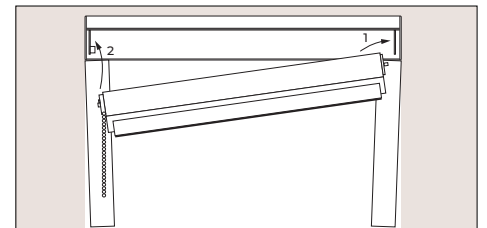

Step 7 - Fix the side channels

Once the roller blind is installed, insert the bottom bar with the fabric into the side channels on both sides. Using the previously drilled fixing holes, mark the screw positions with a pencil through the holes in the side channels. Drill and plug the wall as required, then securely fix the cassette and side channels using appropriate fittings (screws and fixings not supplied).

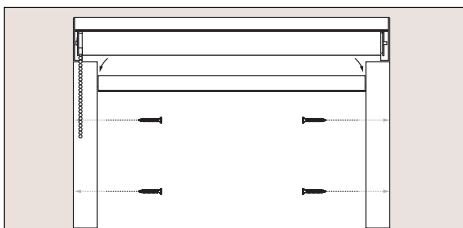

Step 8 - Fit the Cassette Cover

Attach the cover to the cassette by inserting it into the cassette groove. Swing it closed and apply upward pressure until it clicks into place. Secure the cover using the two provided safety screws.

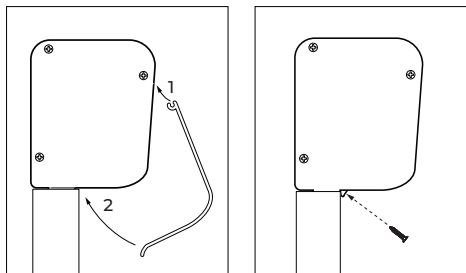

Fitting the safety device: 'P' Clip 400990

This procedure can be completed by non-professionals.

Step 1 - Attach the 'P' Clip to the Chain

Once the blind is securely fitted, attach the 'P' Clip to the control chain.

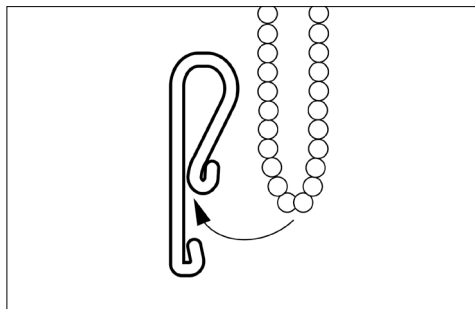

Step 2 - Mark fixing points

Pull the chain taut with the device, placing it as far from the control mechanism as possible. This keeps the chain tight, preventing slack and enhancing child safety. Once positioned, mark through the screw holes to indicate where the device will be fixed.

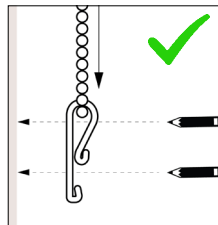
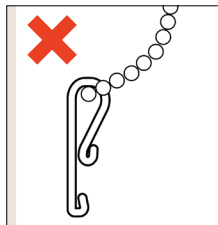

Step 3 - Secure the Device

Move the device to one side and, using the marks made in Step 2, drill and plug the holes. Then reposition the device and fix it into place, ensuring it is securely mounted.

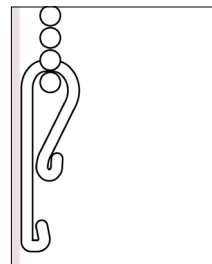
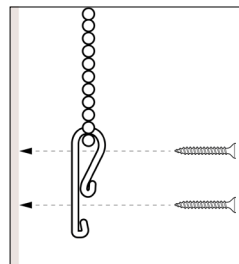

Note: If your blind has been supplied with a different safety device, please refer to the specific installation instructions available on our website for that device - www.decorquip.com

WARNING

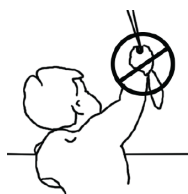

Young children can be strangled by loops in pull cords, chains, tapes and inner cords that operate the product.

To avoid strangulation and entanglement, keep cords out of the reach of young children. Cords may become wrapped around a child's neck.

Move beds, cots and furniture away from window covering cords.

Do not tie cords together. Make sure cords do not twist and create a loop.

Always fit the chain and rear cord safety devices.

Operation & Maintenance

Warning! The operating instructions must be read before operating the blind.

Operating instructions - Chain controlled

1. To lower the fabric on the roller blind gently pull the operating chain closest to the window.
2. To raise the fabric on the blind gently pull the operating chain furthest from the window.

Operating instructions - Motorised rollers

Please check the Motorisation Instructions supplied with this blind prior to operating.

Maintenance Instructions

This product is designed to be maintenance-free; however, we recommend carrying out regular visual inspections to ensure that no components are damaged, as this could lead to operating difficulties or pose a safety risk. If any maintenance is required, it should be completed promptly by a reputable blind company.

For light cleaning, gently wipe or dust the fabric with a soft brush or duster.

For safety and performance, do not make alterations to the blind, chain, or safety device.